



Spareparts



EXCENTERSCHUURMACHINE - HANDPALM

PONCEUSE EXCENTRIQUE - MINI

CE

Bestelnr./N° de cde. 29063

29063 - EXCENTERSCHUURMACHINE

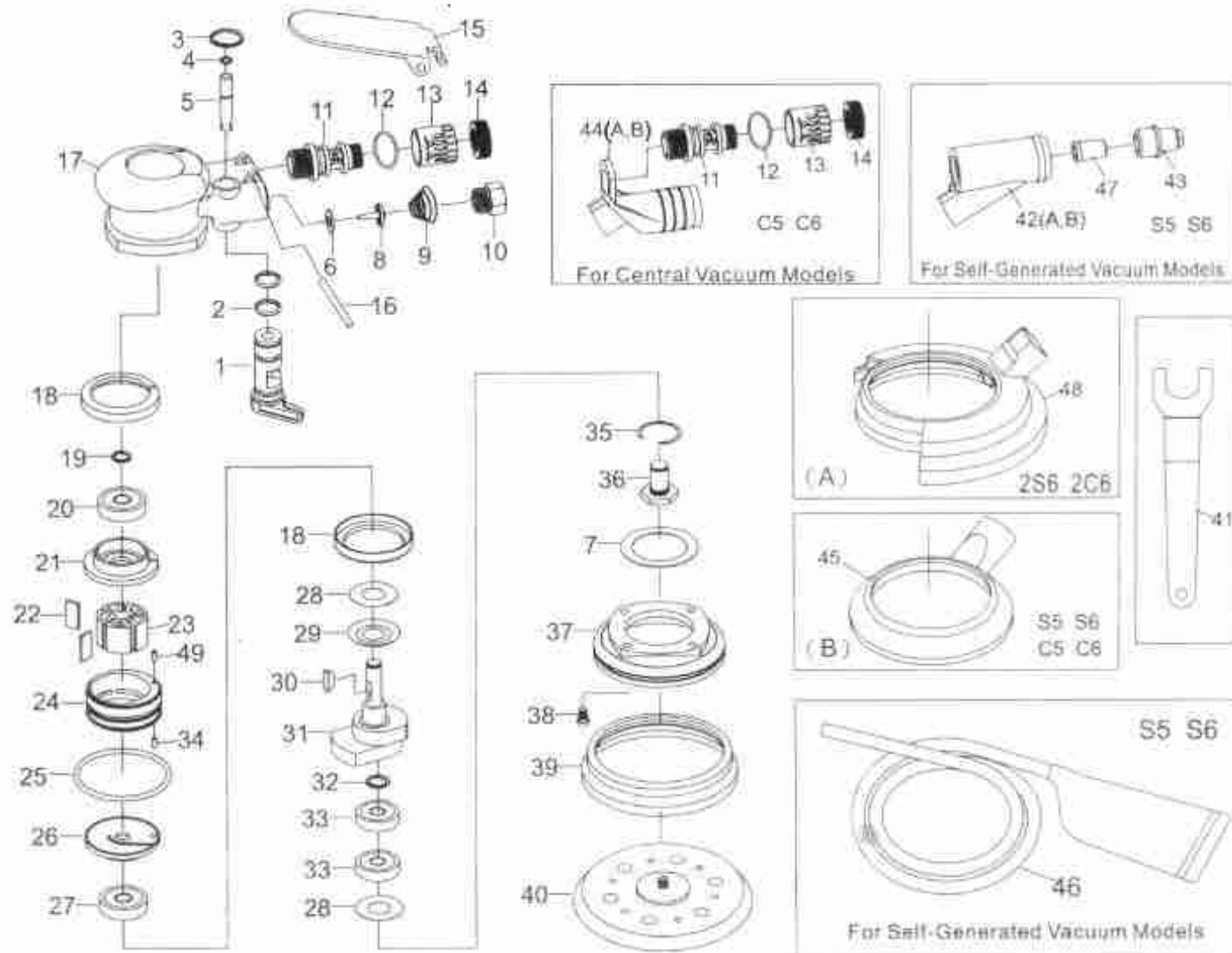

WE RESERVE THE RIGHT FOR ANY DESIGNING CHANGES TO THE PARTS AND WITHOUT ANY NOTICEMENT IN ADVANCE.

NO.	PART NO.	DESCRIPTION	QTY
01	OB-01	REGULATOR	1
02	OB-02	O-RING	2
03	OB-03	SNAP RING	1
04	OB-04	O-RING	1
05	OB-05	VALVE STEM	1
06	OB-06	WASHER	1
07	OB-16.1	WASHER	1
08	OB-08	VALVE	1
09	OB-09	SPRING	1
10	70426	AIR INLET	1
11	OB-11	MUFFLER BODY	1
12	OB-11.1	O-RING	
13	OB-11	EXHAUST SLEEVE	
14	OB-11	NUT	
15	OB-13	LEVER	1
16	OB-14	PIN	1
17	OB-15-3	HOUSING	1
18	OB-16	RUBBER BUSHING	2

NO.	PART NO.	DESCRIPTION	QTY
19	70410	SNAP RING	1
20	OB-18	BEARING(6000ZZ)	1
21	OB-19	REAR PLATE	1
22	OB-20	ROTOR BLADE	5
23	OB-21-1	ROTOR	1
24	OB-22	CYLINDER	1
25	OB-24	O-RING	1
26	OB-25	FRONT PLATE	1
27	OB-26	BEARING(6002ZZ)	1
28	OB-28.1	WASHER	2
29	E-29	WASHER	1
30	70407	ROTOR KEY	1
31	S560-31	MOTOR SHAFT BALANCER(5")	1
31	S560-29	MOTOR SHAFT BALANCER(6")	1
32	OB-30	SNAP RING	1
33	OB-31.1	BEARING(6001LU)	1
33	OB-31.2	BEARING(6001)	1
34	81326	PIN(3*8)	1

NO.	PART NO.	DESCRIPTION	QTY
35	OB-33	SNAP RING	1
36	S560-34	SHAFT	1
37	OB-35.2	HOUSING COVER	1
38	OB-36	SCREW	4
39	OB-37	SHROUD(N5,N6)	1
40	OB-38.1	PAD 5"	1
40	OB-38.2-12	PAD 6"	1
41	OB-39	STOP SPANNER	1
42A	S560-40.1	VACUUM ADAPTER(S5,S6)	1
42B	S560-40	VACUUM ADAPTER(2S6)	1
43	OB-42.1	MUFFLER BODY(S5, S6)	1
44A	S560-41.1	VACUUM ADAPTER(C5,C6)	1
44B	S560-41	VACUUM ADAPTER(2C6)	1
45	OB-42	SHROUD(S5,S6) (C5,C6)	1
46	OB-46-2	RUBBER HOSE & BAG(S5,S6)	1
47	2HG-02	CONE MUFFLER	1
48	S560-47	SHROUD(2S6, 2C6)	1
49	OB-23	PIN	1