

Spareparts



SLIJPMOLEN PSM 200 W
TOURET A MEULER PSM 200 W

CE

Bestelnr./N° de cde. 51105

PSM 200 W

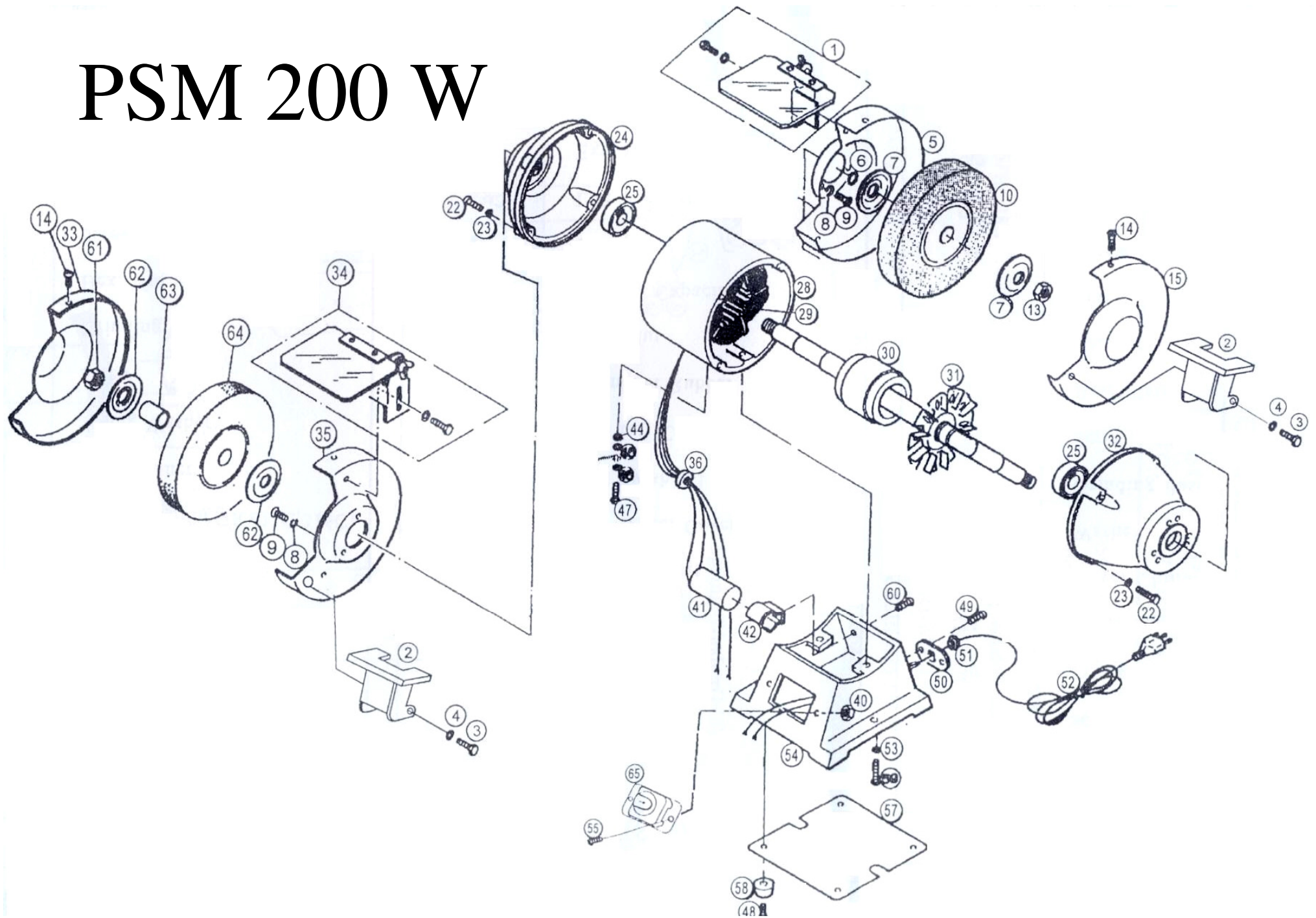

REF.NO.	PARTS NAME
1	Right Eye Shield
2	Right Toolrest
3	Hex. Bolt
4	Washer
5	Right Int. Cover
6	Snap Ring(For GR 611C,316C)
7	Disc Washer
8	Spring Washer
9	Screw
10	Grinding Wheel
13	Hex. Nut
14	Screw
15	Right Wheel Cover
22	Screw
23	Spring Washer
24	Left Support
25	Ball Bearing

REF.NO.	PARTS NAME
28	Stator Housing
29	Stator
30	Rotor
31	Fan
32	Right Support
33	Left Wheel Cover
34	Left Eyeshield
35	Left Int. Cover
36	Grommet Rubber
40	Hex. Nut
41	Starting Capacitor
42	Clamp
43	Left Toolrest
44	Ext. Washer
45	Copper Set
46	Int. Washer
47	Screw

REF.NO.	PARTS NAME
48	Screw
49	Screw
50	Fixing Plate
51	Cable Strainer
52	Power Cord
53	Washer
54	Grinding Base
55	Screw
57	Base Plate
58	Pad
59	Screw
60	Screw
61	Hex. Nut-Left Thread
62	Dise Washer
64	Grinding Wheel
65	NVR Switch